

Assessore ai Lavori Pubblici
Salvino 4 Anni Terzica
Dirigente del Servizio
Responsabile Unico dell'Procedimento

Roberto Cavemiri
Servizio AS Edilizia Pubblica e Comuni
Ing. Paolo Barattini
Arch. Luca Panfili

Progettisti

Progettista opere architettoniche
Arch. Mauro Frati - Capogruppo
Arch. Piero Vincenti
Arch. Augusto Andriolo
Arch. Nicola Bossi

Progettista opere strutturali
Ing. Andrea Rigano

Progettista impianti meccanici ed elettrici
PROTECNO Engineering srl

Consulting Engineering & Project Management & Sustainable Energy Systems
Consulting progettazione acustica
Studio FRA, Fico srl

Coordinatore sicurezza in fase di progettazione
Arch. Luca Panfili

Tavola: **S609**
Scala: 1:100 1:10
Spazio riservato agli uffici

LOCALIZZAZIONE MODULI BASE E MODULO 04

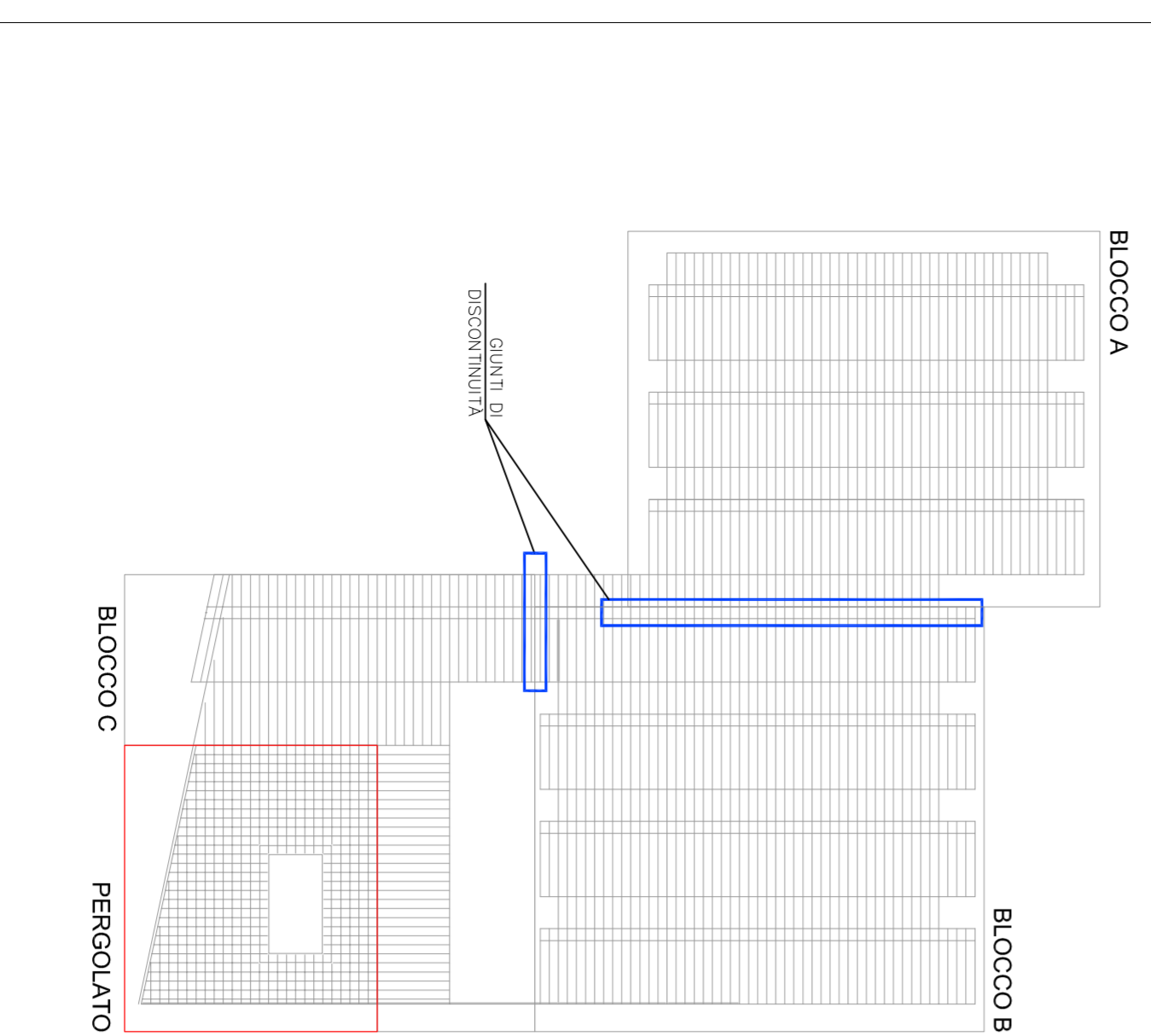

POSIZIONE	MATERIALE	b[cm]	h[cm]	e[cm]
TRAVI COPERTURA				
T06	TRAVI PERGOLATO	GL24h	20	48
T07	TRAVI CASSONATO	GL24h	14	28
T08	TRAVI CASSONATI	GL24h	16	32
T09	TRAVI ESTERNA	GL24h	20	64
T10	TRAVE DI CORONAMENTO	GL24h	16	44
T11	TRAVE DI COLLEGAMENTO	GL24h	20	28

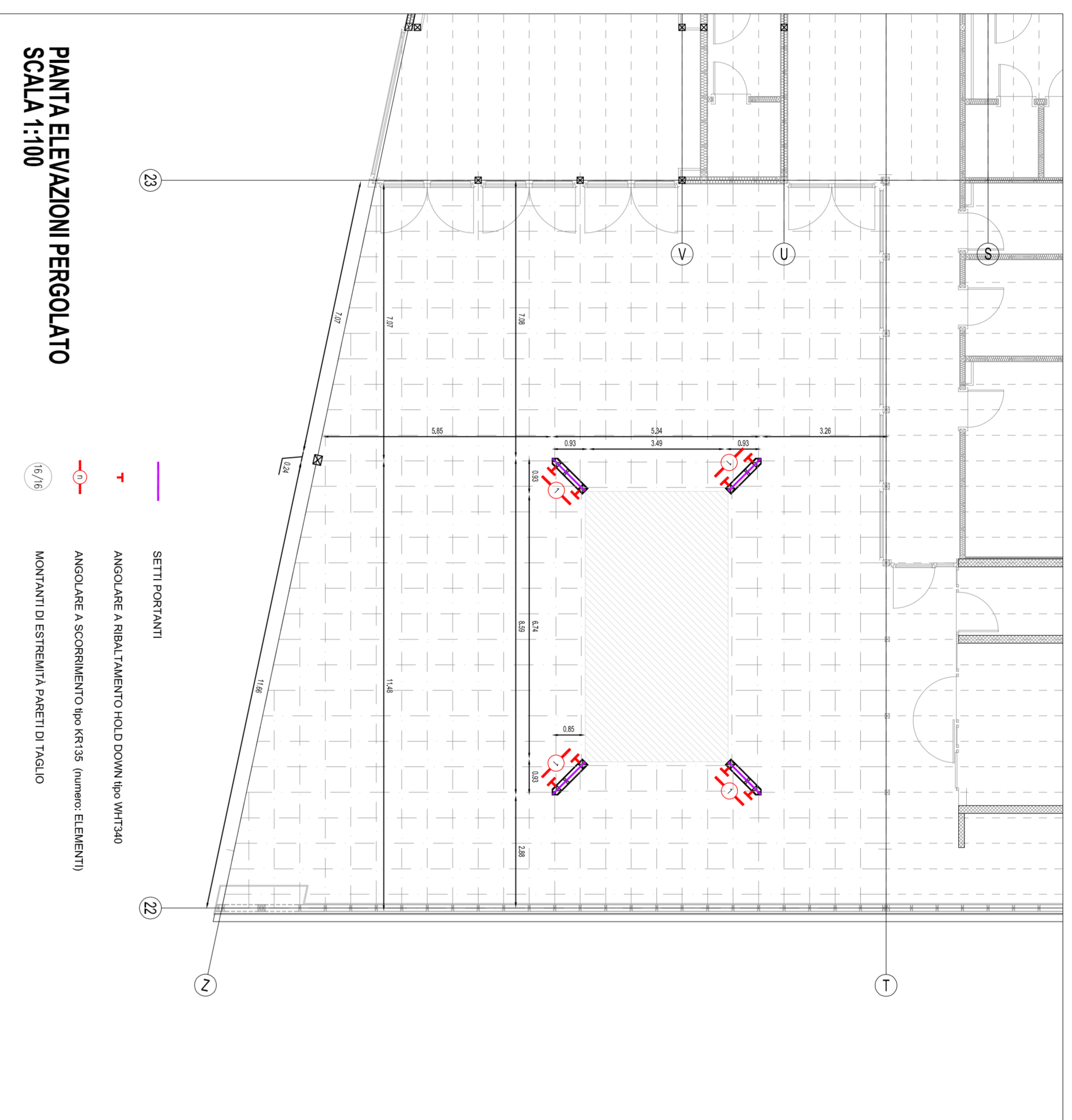

PIANTA ELEVAZIONI PERGOLATO
SCALA 1:100

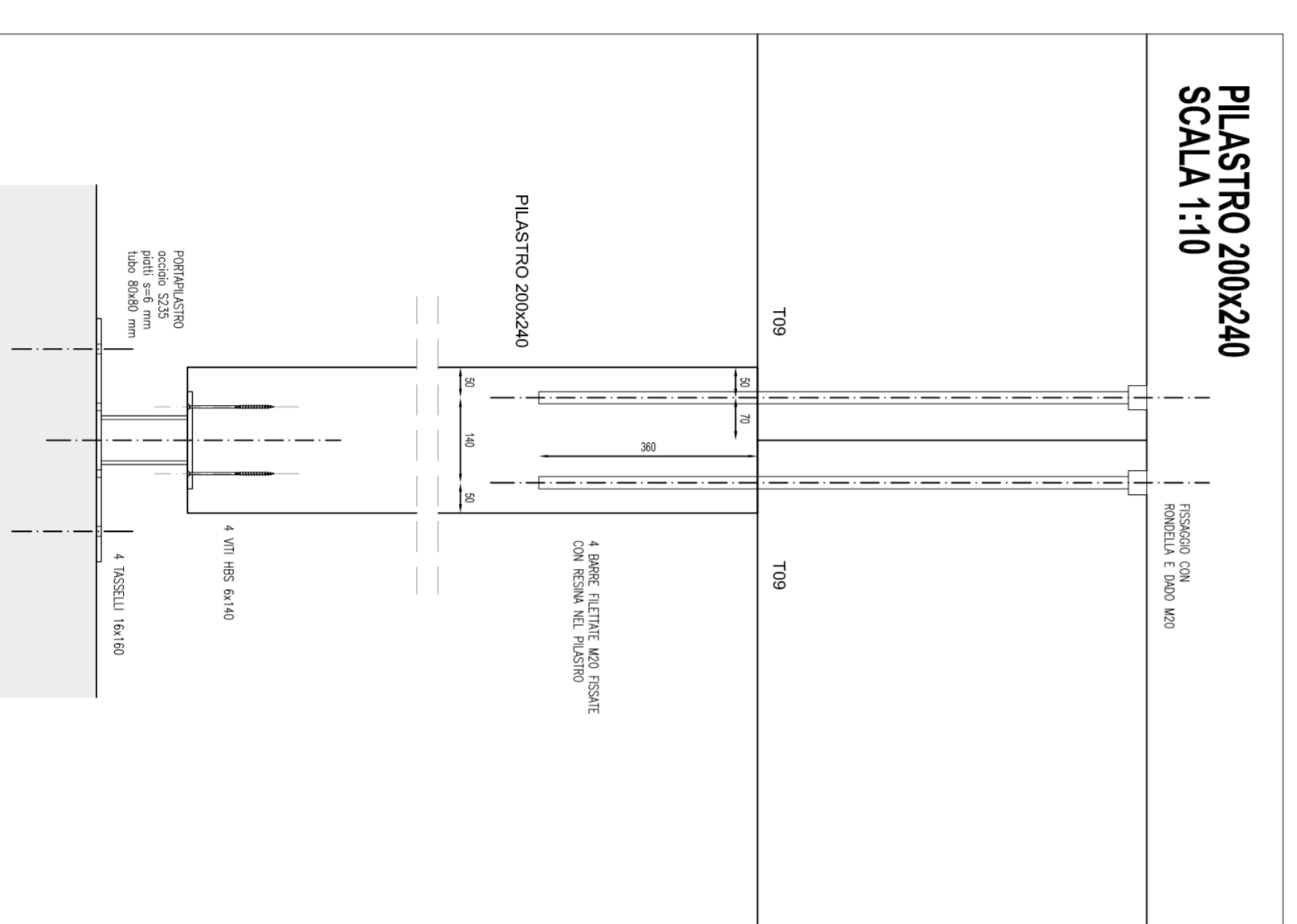

PIASTRA DI BASE
SCALA 1:10

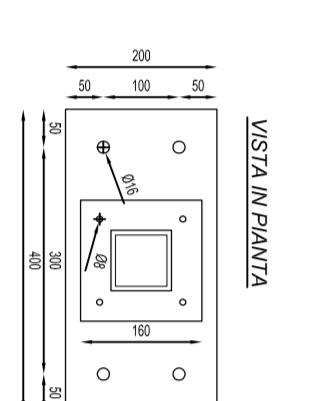

NODO PILASTRO - T09
SCALA 1:10

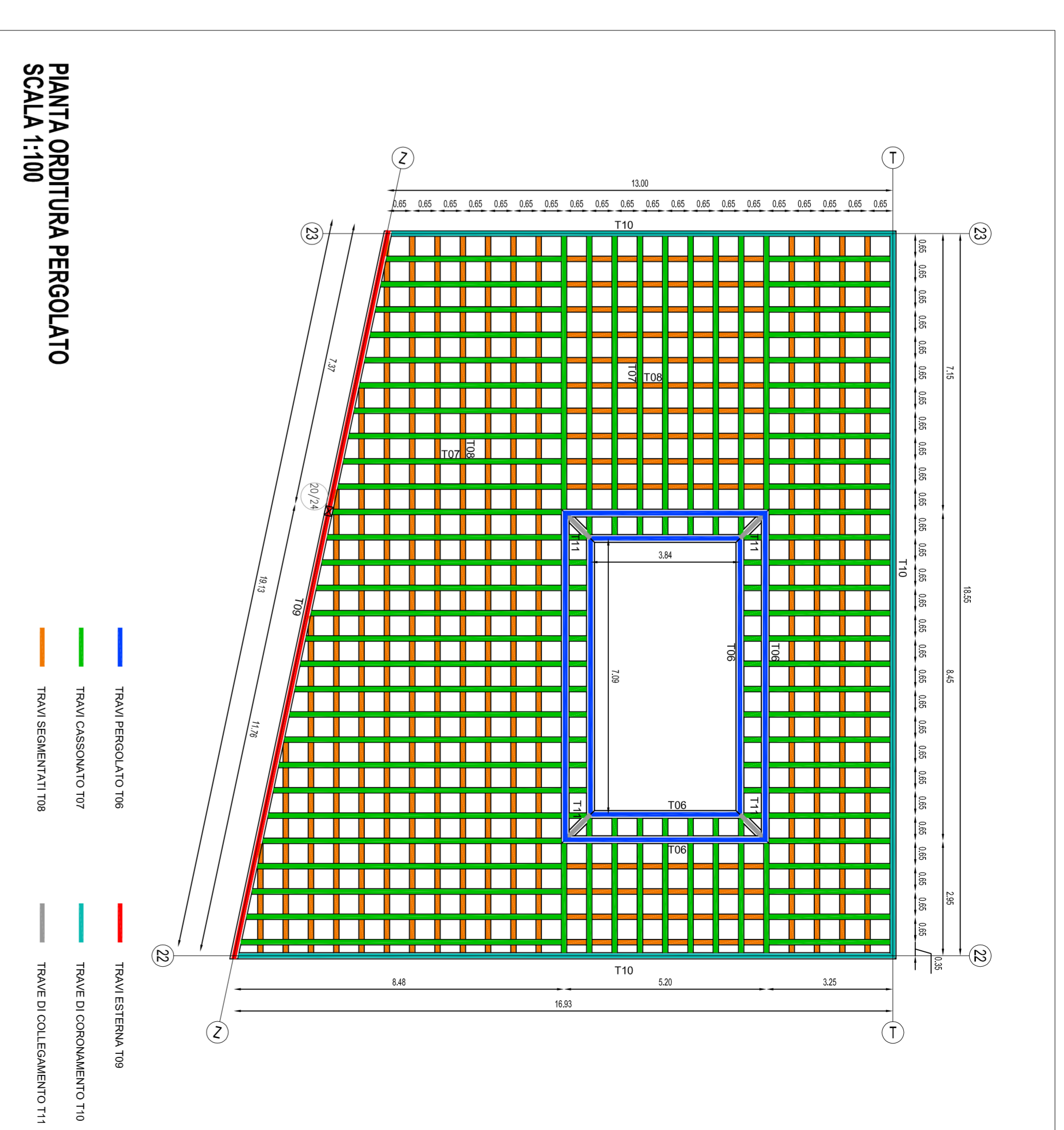
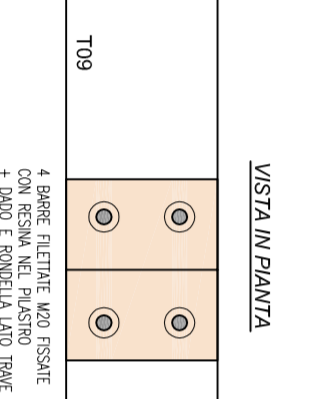

PIANTA ORDITURA PERGOLATO
SCALA 1:100

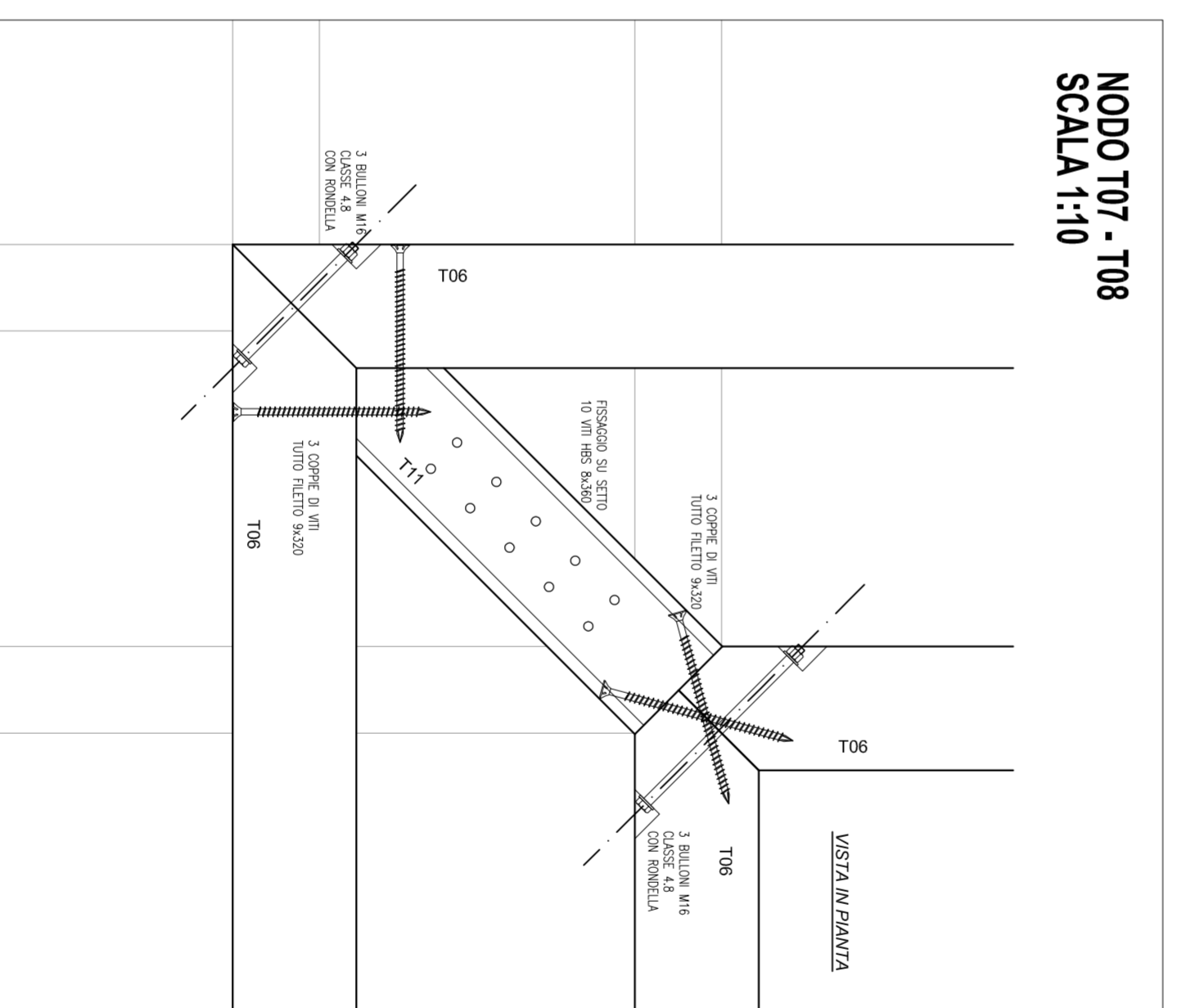

NODO T07 - T08
SCALA 1:10

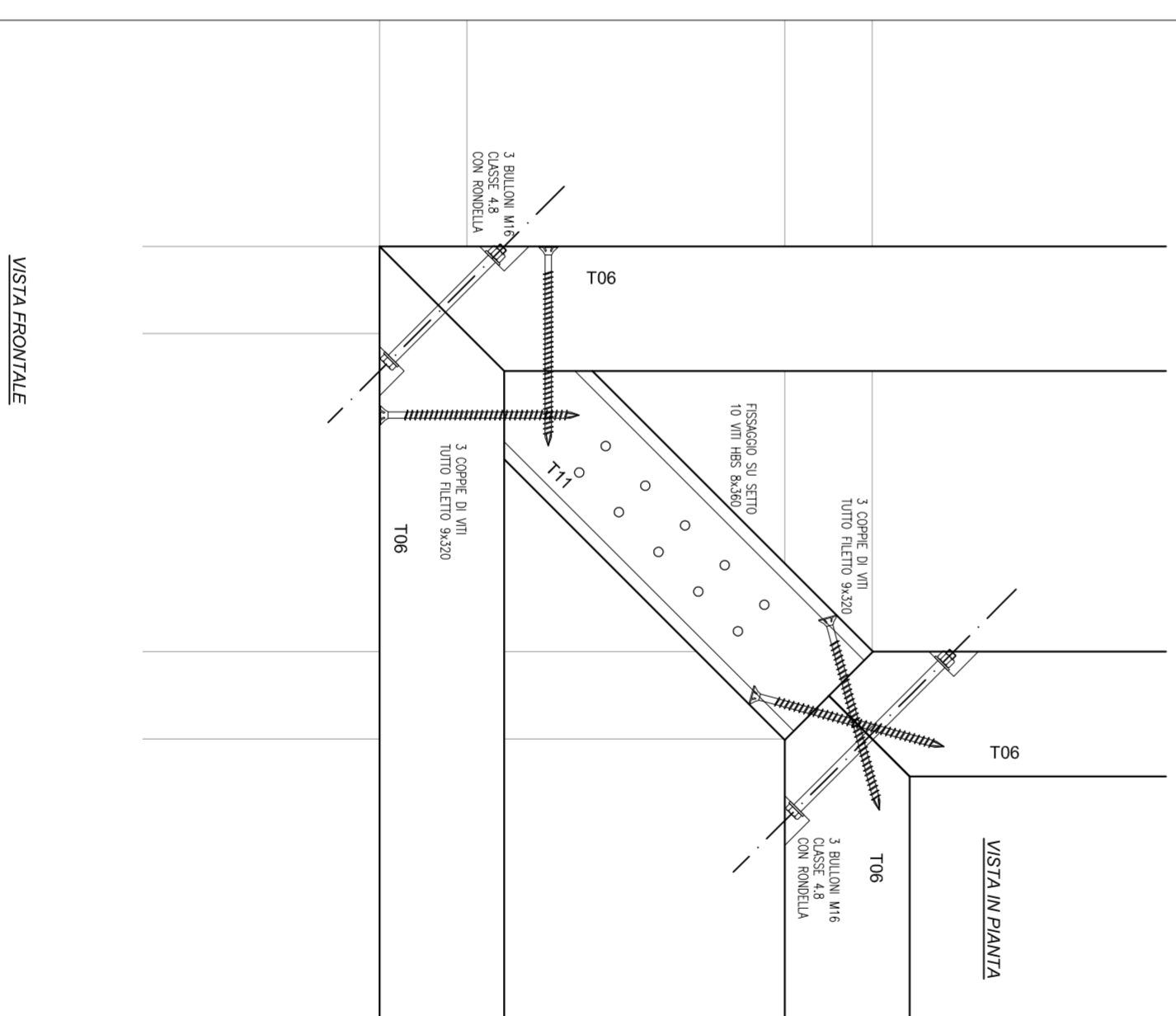

VISTA IN PIANITA'

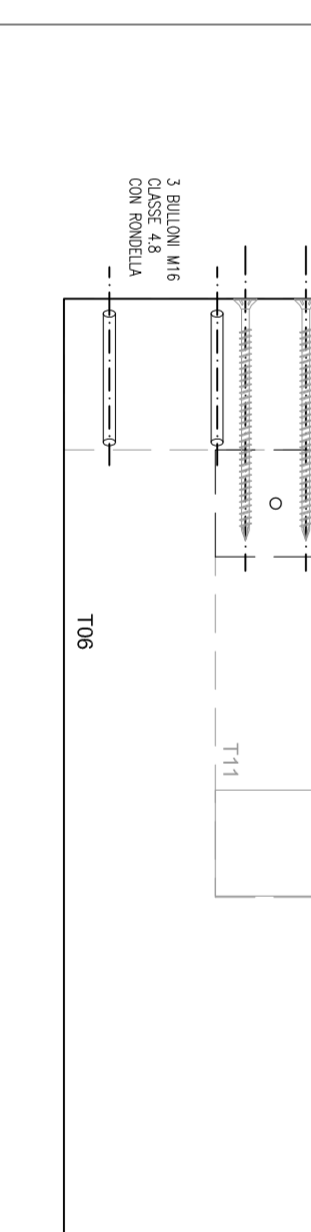

NODO T07 - T08
SCALA 1:10

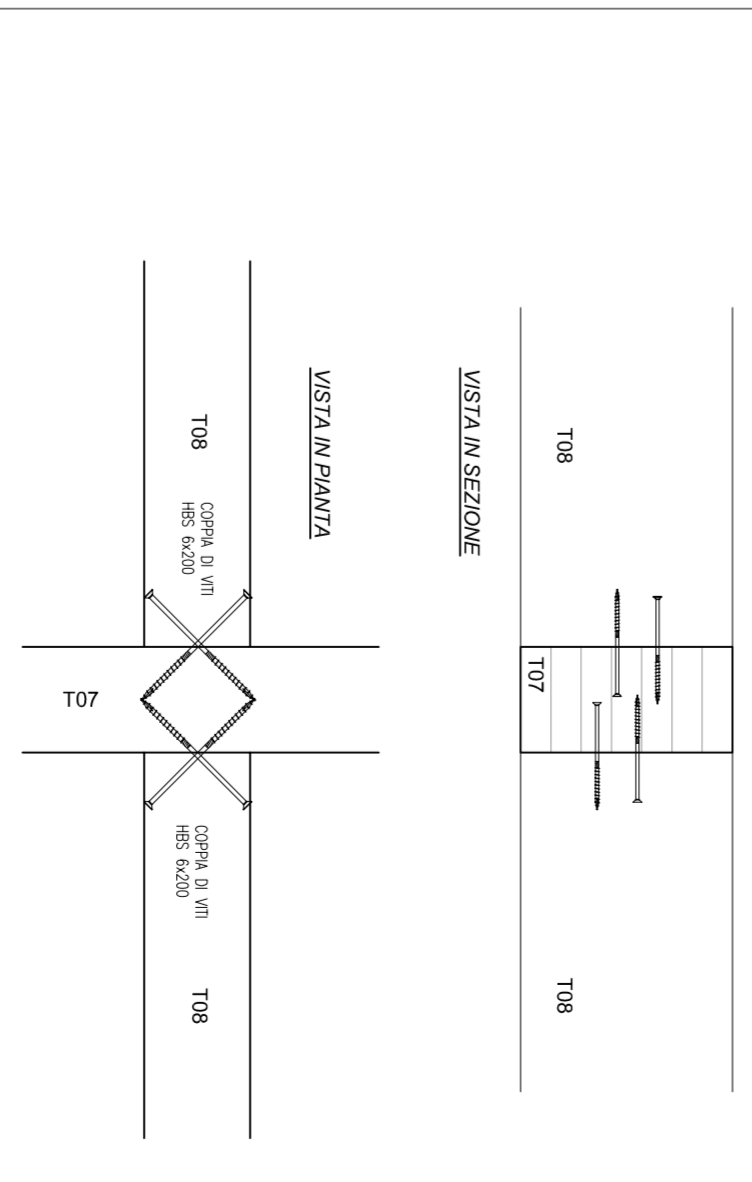

NODO T07 CON T06-T09-T10
SCALA 1:10

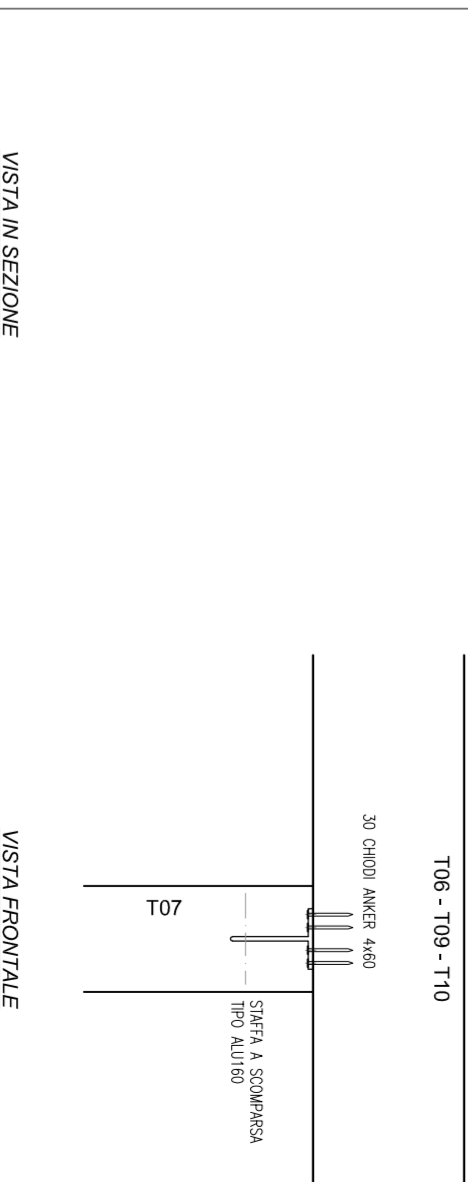

VISTA IN SEZIONE

